

WITHOUT HIGH FREQUENCY

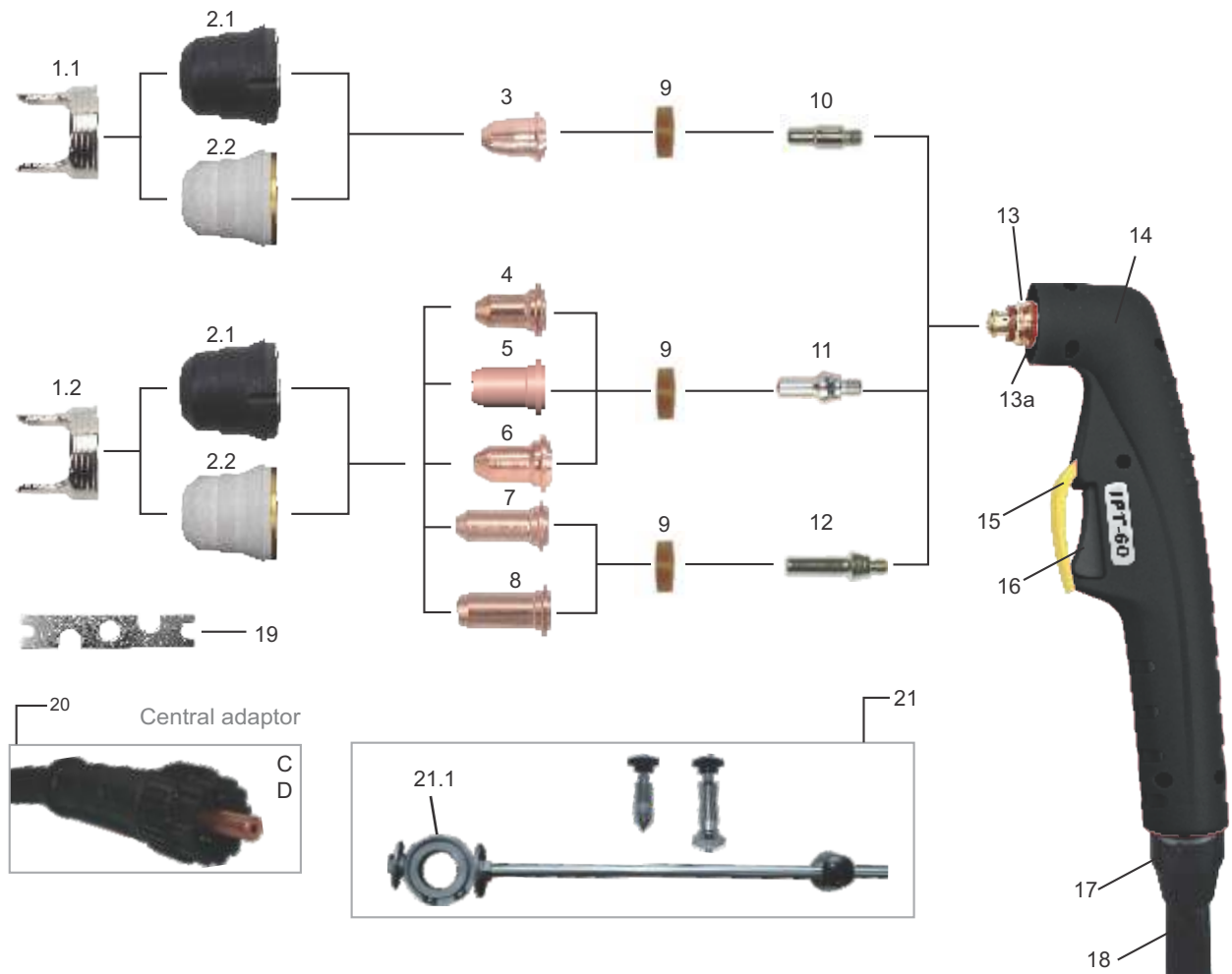

For the correct operation please use:
3-Ways Solenoid Valve, inside orifice $\phi 2.3-2.7\text{mm}$

TECHNICAL DATA

- Current: 60Amp
- Duty cycle: 60%
- Gas: Air/N₂
- Gas Pressure: 4.5-5.0 Bar
- Gas Flow 120-130LPM
- Ignition: Without HF
- Post Flow: 55sec. recommended
- Standard Length: 6m



EN 60974-7

Position	Code/Ordering Information	Ref.	Description
(With "●" is the standard configuration)			
1			Double pointed spacer;
1.1	ISM0098-01		Double pointed spacer/IPT60;
● 1.2	ISM0098	60432	Double pointed spacer/IPT60/backing striking;
2			Outside nozzle;
● 2.1	IVS0661-03	60389	Outside nozzle 6holes IPT60/bakelite;
2.2	IVS1661-05		Outside nozzle 6holes IPT60/Gray Glass fiber;
3			Tip;
3.1	IVU0661-06	PD0116-06	Tip Φ 0.6mm/20A IPT60; Φ 0.6mm/20A/IPT60
3.2	IVU0661-08	PD0116-08	Tip Φ 0.8mm/30A IPT60;
3.3	IVU0661-09	PD0116-09	Tip Φ 0.9mm/40A IPT60;
4			Tip;
4.1	IVU1660-06	51318.06	Tip Φ 0.6mm/20A IPT60/back striking;
4.2	IVU1660-08	51318.08	Tip Φ 0.8mm/30A IPT60/back striking;
4.3	IVU1660-09	51318.09	Tip Φ 0.9mm/40A IPT60/back striking;
4.4	IVU1660-10		Tip Φ 1.0mm/50A IPT60/back striking;
5	IVU1667-09	51312P.09	Tip Φ 0.9mm/40A IPT60/Contact cutting/back striking;
6			Tip;
6.1	IVU1668-10	51313P.10	Flat tip Φ 1.0mm/50A IPT60/backing striking;
● 6.2	IVU1668-11	51313P.11	Flat tip Φ 1.1mm/60A IPT60/backing striking;
7			Tip;
7.1	IVU1609-06	51318L.06	Extended tip Φ 0.6mm/20A IPT60/backing striking;
7.2	IVU1609-08	51318L.08	Extended tip Φ 0.8mm/30A IPT60/backing striking;
8			Tip;
8.1	IVU1603-09	51314.09	Extended tip Φ 0.9mm/40A IPT60/ Contact cutting/ backing striking;
8.2	IVU1603-10		Extended tip Φ 1.0mm/50A IPT60/ Contact cutting/ backing striking;
● 9	IVF1601	60028	Diffuser IPT20C-IPT60;
10	IVB0660	PR0110	Electrode Plasma IPT20C-IPT60;
● 11	IVB1048	52582	Electrode Plasma IPT20C-IPT60/backing striking;
12	IVB1049	52583	Extended electrode IPT20C-IPT60/backing striking;
13	IVZ0076		IPX-45/60 hand torch head;IPX-45/60
13a	IFT0709	51620.60	"O"ring Φ 15X Φ 18 IPT60 RED SIL;O
14	IGV0038-01		Plasma handle manual/IPT20-60/PX torch head;
15	IHJ0722		Protection part/Plasma/Yellow;
16	IHQ0070	07301.20	Trigger red; 21.8MM
17	IHJ0898		Plasma Joint/IPT20-60;
18			Cable assembly;
18.1	IVN01106060-22		Cable assembly/IPT60/6M/2 wires/centre adaptor;
18.2	IVN01106063-22		Cable assembly/IPT60/6M/2 wires/integrated;
18.3	IVN01106066-22		Cable assembly/IPT60/6M/4 wires/centre adaptor;
18.4	IVN01106061-22		Cable assembly/IPT60/6M/2 wires/PX torch head/separate;
19	ICG6006		Spanner for Plasma;
20	IZX0078		Central adaptor torch side Plasma 5 pins;
21	ISM0707		Circle cutting attachment;
21.1	ISM0673		Roller stand IPT20C-60 / with spanner;
22	ISM0032		Circle cutting attachment/IPT20-60;
22.1	ISM0702		Wheel spacer with spanner IPT20-60;